

## MD003003

### Gearbox Specifications

Outer diameter	3mm	Bearing	Porous bearing
Material	Metal	Axial endplay	≤0.3mm
Direction of rotation	cw & ccw	Radial loading on output shaft	≤0.3N
Gear backlash	≤3°	Operating temperature range	-20 ~ +85°C

### Gearbox Stages

	1	2	3	4
Reduction ratio	5	25	125	625
Max rated torque of gearbox (gf.cm)	50	50	50	50
Instant torque of gearbox (gf.cm)	150	150	150	150
Gearbox efficiency (%)	85	73	65	58
Gearbox length L1 (mm)	6	7.5	9	10.5

### Technical Drawing

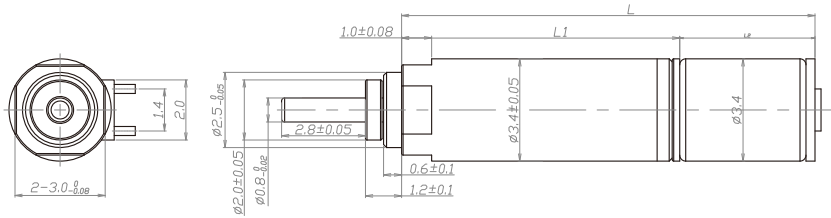

### Motor Specifications

Motor type	Stepper motor	Input speed	≤10000rpm
Voltage	3V	Current	50mA max

Model	Speed at 2400pps	Max Rated Torque	Max Instant Torque	Reduction Ratio	Gearbox Length	Overall Length
	rpm	gf.cm	gf.cm		mm	mm
MD003003-5	1440.0	50	150	5	6.0	10.75
MD003003-25	288.0	50	150	25	7.5	12.25
MD003003-125	57.6	50	150	125	9.0	13.75
MD003003-625	11.5	50	150	625	10.5	15.25

\*Please contact us for customized products