

## PD004004

### Gearbox Specifications

Outer diameter	4.3mm	Bearing	Porous bearing
Material	Plastic	Axial endplay	≤0.3mm
Direction of rotation	cw & ccw	Radial loading on output shaft	≤0.3N
Gear backlash	≤3°	Operating temperature range	-20 ~ +85°C

### Gearbox Stages

	1	2	3	4
Reduction ratio	6	36	216	1296
Max rated torque of gearbox (gf.cm)	70	70	70	70
Instant torque of gearbox (gf.cm)	200	200	200	200
Gearbox efficiency (%)	85	73	65	58
Gearbox length L1 (mm)	6.18	7.67	9.17	10.72

### Technical Drawing

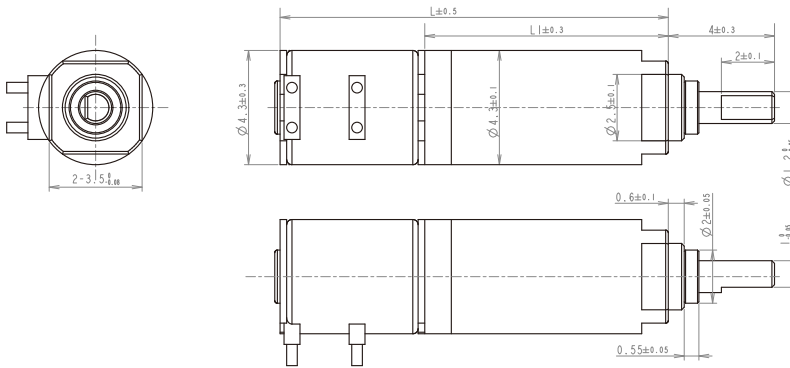

### Motor Specifications

Motor type	Stepper motor	Input speed	≤10000rpm
Voltage	3V	Current	50mA max

Model	Speed at 2000pps	Max Rated Torque	Max Instant Torque	Reduction Ratio	Gearbox Length	Overall Length
	rpm	gf.cm	gf.cm			
PD004004-6	1000.0	140	400	6	6.18	11.78
PD004004-36	166.6	140	400	36	7.67	13.27
PD004004-216	27.7	140	400	216	9.17	14.77
PD004004-1296	4.6	140	400	1296	10.72	16.32

\*Please contact us for customized products